



DESCRIPTION

**Decals for walls**

TECHNICAL DATA

PSFRESCO is made of a 30 gr/m<sup>2</sup>, 150-200 µm **non woven fabric carrier** and a 20-25 µm **stratified polymeric finish**. It is supplied with a **paper protection**.

EQUIPMENT

Solvent-ecosolvet, latex printing plotter +  
 - wide wall paper brush/ wide brush  
 - soft rubber roller  
 - paint brush  
 - specific liquids



SUITABLE FOR

Ideal for interior and exterior walls, floors, lining, street furniture, concrete, but also for wood, marble and stone. Excellent, in general, for any breathable, not plastic, slightly porous surface.

**Internationally patented** PSFRESCO consists of a **digitally pigmented sheet that shifts "only the color"** directly into the pores of the surface that must be decorated without changing its features and **integrating with any paint on it**. It ensures **excellent scratch resistance**. The application requires a **specific liquid**.

FEATURES

INSTRUCTIONS

1



**Remove** the paper liner before printing.

**Note:** These instructions are strictly for wall decorations. Please see our **video tutorials** for application on **wood, marble and plaster** at [www.youtube.com/user/digidecor.it](http://www.youtube.com/user/digidecor.it)

2

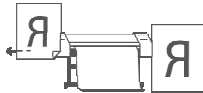

**Print** on the smooth side of the non woven fabric (smooth side) with the **proper color profile** depending on the type of plotter/ink. The **heat bars** should be set to 35 °C to 40 °C. **Print in mirror mode**.

3

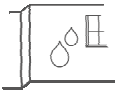

**Prepare the wall** with a coat of **wall primer** (AU EFISS1-diluted with 300% water) and 2 coats of **white paint** (AU ETINTA2-diluted with 20-30% water). **Wait at least 8 hours before next step**. **Thoroughly wet** the area which will be decorated with the **application mixture** (AU EMISCAS-diluted with 100% water). The liquid layer should be at least a 1 mm. **Now place and adjust the printed sheet** on the wall.

4

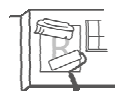

**Carefully spread the printed sheet** using the **wall paint brush** (AU ESPAZ1152) to remove possible air bubbles and then with the **rubber wall roller** (AU ERUL113015) to remove remaining liquid.

5



**After 15-20 minutes** hit the decoration with the large brush (AU ESPAZ1152) so that it sticks perfectly on the wall.

6

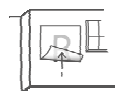

**After at least 8 hours**, sprinkle evenly with water using a **brush** (recommended AU EPEN3X12), wait 1'-2' and **remove the sheet**. Then **rinse the decor** with the same brush with **clean water** and let **dry** thoroughly. Finally **protect** the decoration with AU EMISCAS or any other specific protective.

WARNINGS

For best protection use suitable transparent acrylic, vinyl or siloxane. For more information please contact your dealer.

Store in a cool dry place.

Do not expose to direct sunlight.

If properly stored the product will maintain its features for at least 2 years.

STORAGE

The instructions on this sheet are merely indicative and contain details concerning tests carried out in our laboratories with our equipment. Do your own testing. The manufacturer will replace defective material but is not responsible for any damage resulting from incorrect use.

**Available sizes:** 1220mm x 50mt - 1220mm x 25mt - 1220mm x 12mt - 610mm x 25mt - 610mm x 3mt - 500mm x 25mt